

INSTALLATION INSTRUCTIONS FOR 6600 & F6600 RIM EXIT DEVICE

※ The screws (item C & D), attach both machine & TEK screws (for wood door installation). And Item B1 & B2 changed to TEK screws (self-drilling screws) since 2014, May.

How to determine hand of door

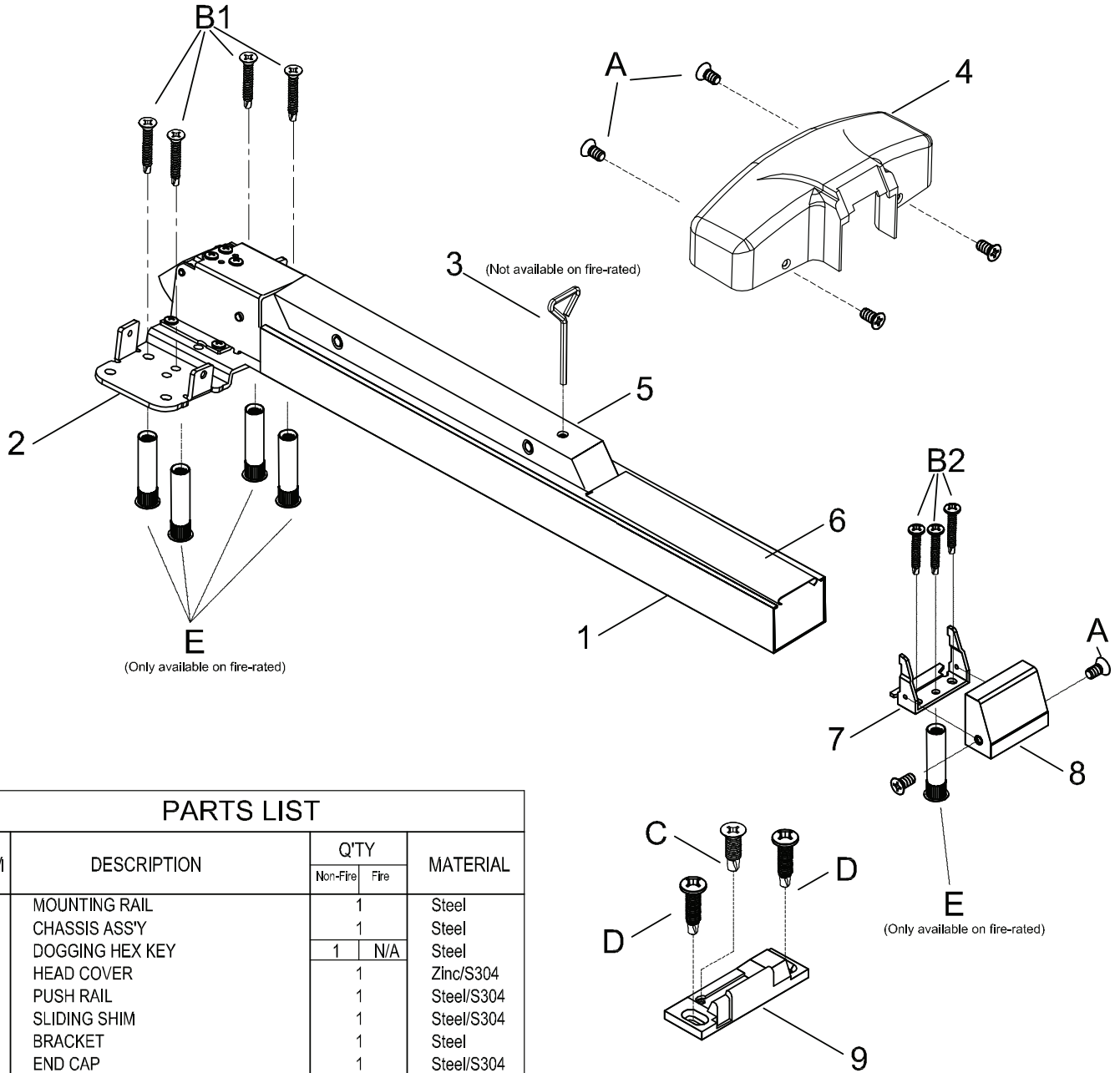
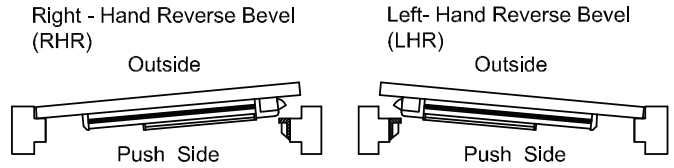

PARTS LIST

ITEM	DESCRIPTION	Q'TY		MATERIAL
		Non-Fire	Fire	
1	MOUNTING RAIL	1		Steel
2	CHASSIS ASS'Y	1		Steel
3	DOGGING HEX KEY	1	N/A	Steel
4	HEAD COVER	1		Zinc/S304
5	PUSH RAIL	1		Steel/S304
6	SLIDING SHIM	1		Steel/S304
7	BRACKET	1		Steel
8	END CAP	1		Steel/S304
9	STRIKE	1		Steel
A	SM4X8 FLAT HEAD SCREWS	6		S304
B1	10#1½" TEK SCREWS (FLAT HEAD)	4	N/A	Steel
B2	10#1¼" TEK SCREWS (ROUND HEAD)	3	2	Steel
C	12# ¾" SCREWS (FLAT HEAD)		1+(1)	Steel
D	12# ⅝" SCREWS (ROUND HEAD)		2+(2)	Steel
E	SEX BOLT	N/A	5	Steel

STEP 1: MARK CENTER LINES

※ If necessary, add strike shim under strike for $\frac{3}{16}$ " (4.8mm) as dimension shown

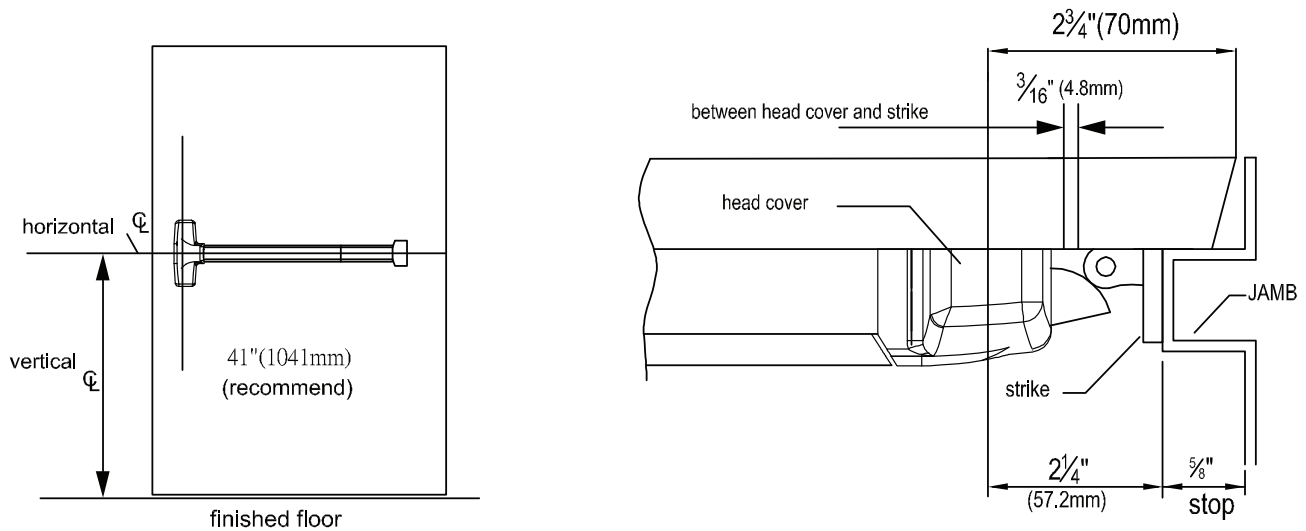

STEP 2: PREPARE INSTALLATION

※ RHR shown (LHR opposite)

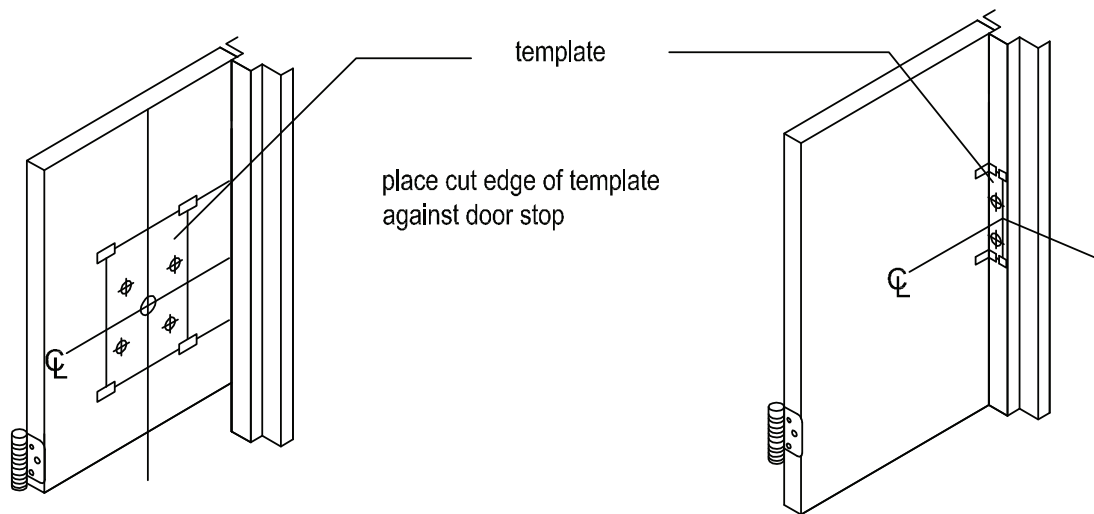

Notice 1 : Tail-piece length

Keep tailpiece $\frac{5}{16}$ "~ $\frac{1}{2}$ " (8~12.7mm) projected.

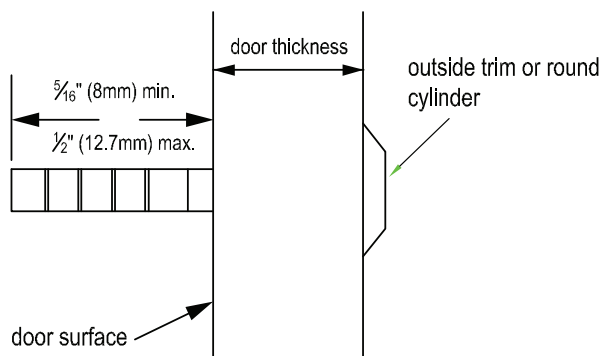

Notice 2: Dogging (For non fire-rated)

Press down the push rail, turn the dogging hex key clockwise or counterclockwise, then the device will change to "Passage" function.

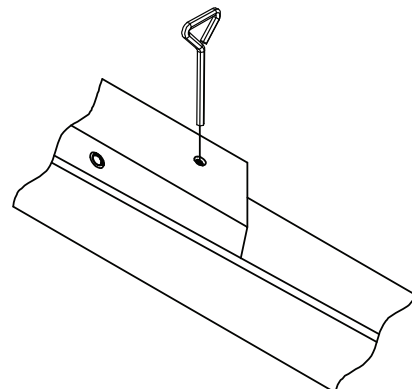

STEP 3: CUT DEVICE IF NECESSARY

3.1 Device length A must be at least $1\frac{1}{2}$ " (38mm) shorter than B

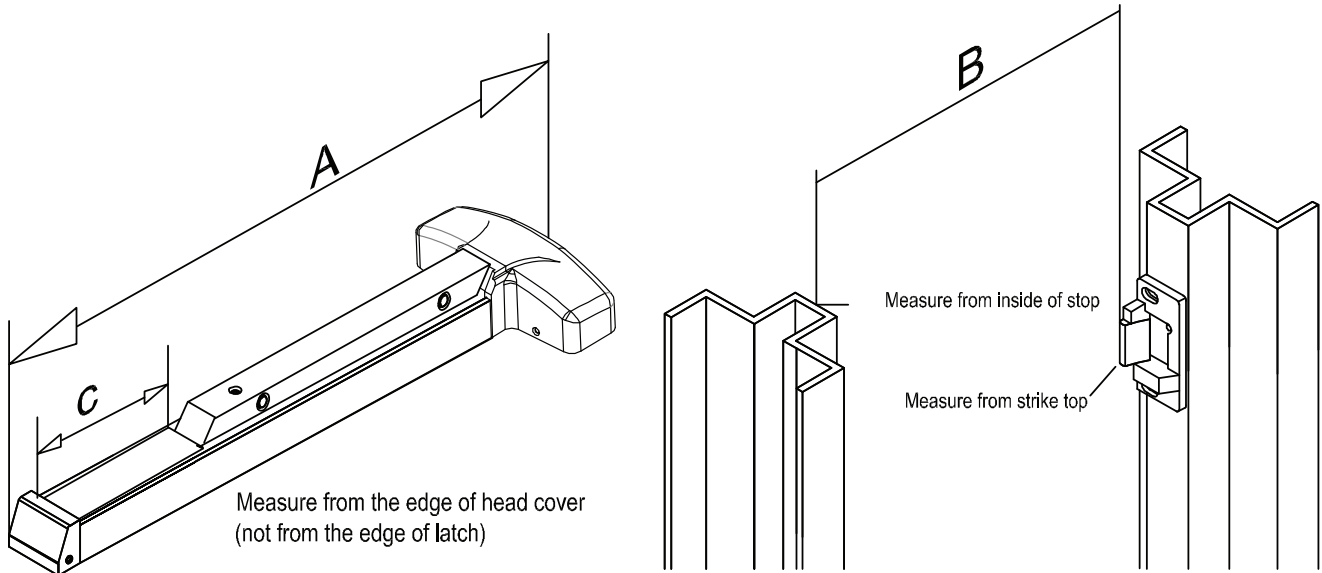

3.2 If necessary, cut length C, so A is at least $1\frac{1}{2}$ " (38mm) shorter than B.

Ensure no gap between sliding shim and push bar end.

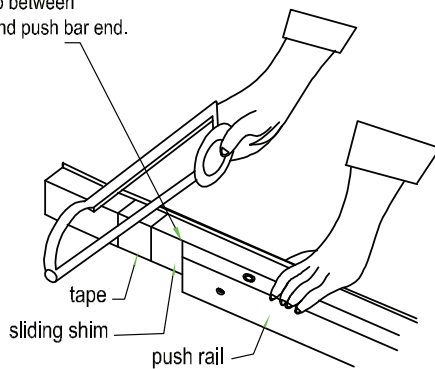

NOTE : the minimum length of the sliding shim must be 1" (25.4mm) or longer than length "C".

3.3 Standard Door Stop is $\frac{5}{8}$ " (15.9mm). Install $\frac{1}{8}$ " (3mm) strike shim if necessary.

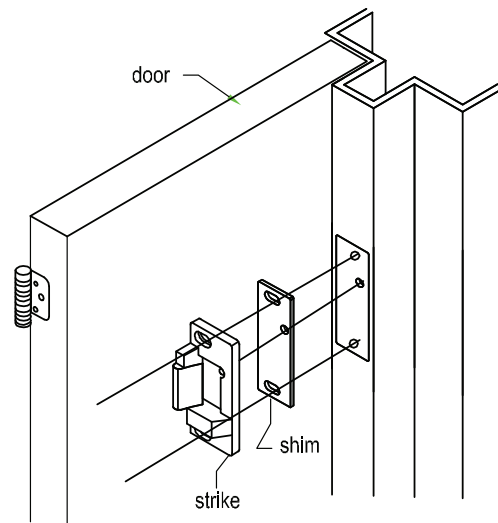

STEP 4 : INSTALL DEVICE

- 4.1 Take off head cover and put device horizontally at the door. Fix screws (B1) on chassis but DO NOT tighten them at this step.
- 4.2 Install bracket with screw (B2). Be sure to remain device being horizontal and then tighten all screws.
- 4.3 Install end cap & head cover.

※ for "FIRE RATED" :
please drill $\varnothing \frac{3}{8}$ " (9.6mm) hole for sex bolt (E)

※ for "NON FIRE-RATED" :
please use screw (B2) directly

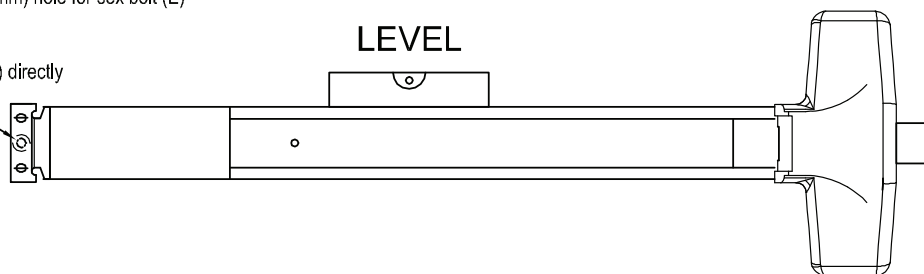

Apply TRIM + CHASSIS - 6600 & F6600 SERIES

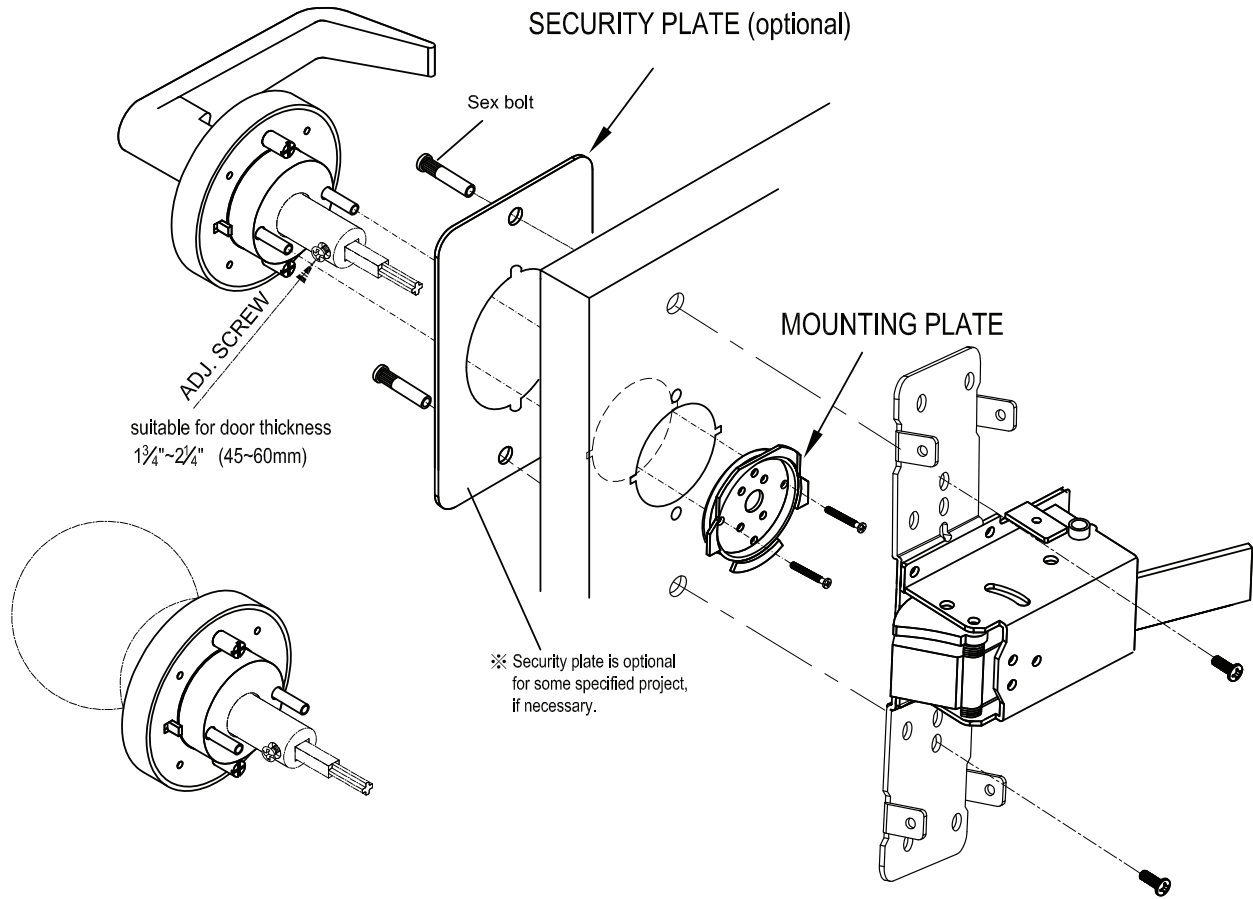

Thumbpiece trim

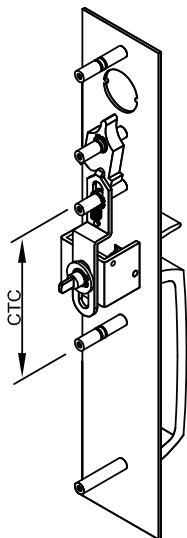

CTC = 4 1/4" (108mm)

Pull trim

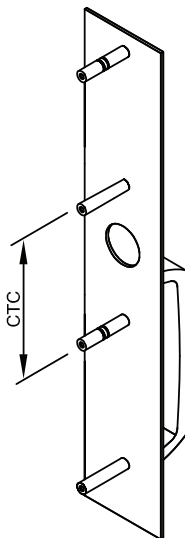

CTC = 4 1/4" (108mm)

Pull trim

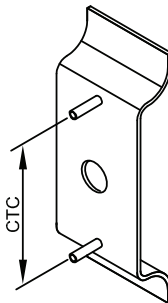

CTC = 3 1/2" (89mm)

ESC lever trim

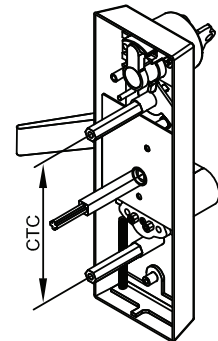

CTC = 4 1/4" (108mm)

Trim with security plate

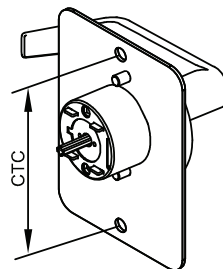

CTC = 4 1/4" (108mm)

Trim w/o security plate

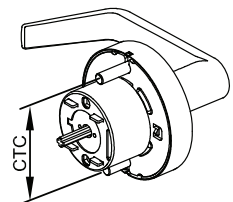

CTC = 2 3/4" (70mm)

TEMPLATE OF 6600 / F6600 RIM EXIT DEVICE (1:1)

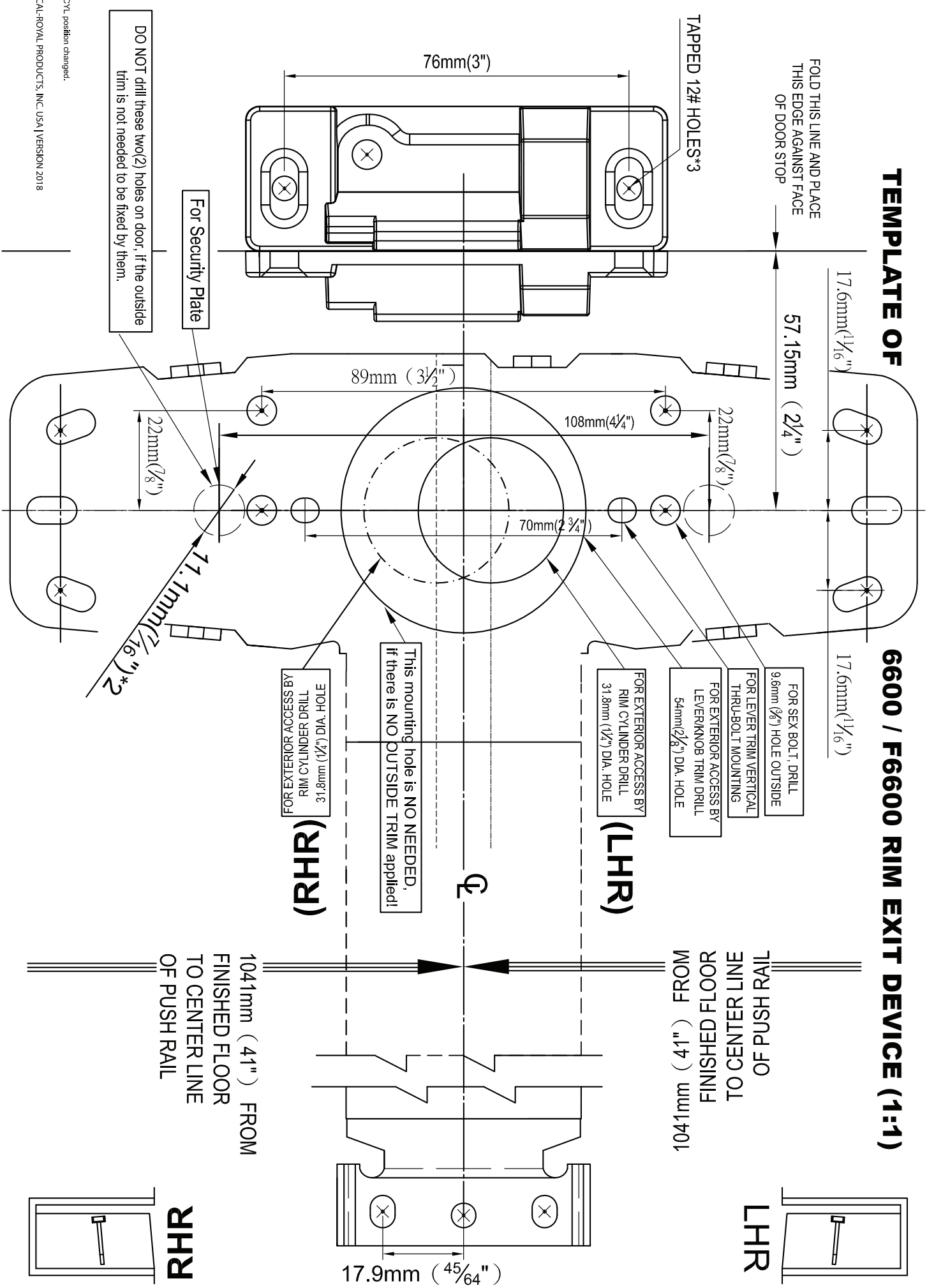

CYL position changed.

CAL-ROYAL PRODUCTS, INC. USA | VERSION 2018