

Alarm Exit Hardware



Features

- 1, 3, 5-minute and continuous alarm type settings available
- ON and OFF power switch
- Alarm sound frequency is 120 db
- Alarm unit has an internal horn. When the push rail is depressed, the horn sounds to provide an audible means of signaling that the door has been opened and breached.
- The key switch to turn alarm off is a standard 1 ¼” cylinder with “C” keyway. The alarm operates on one standard 9-volt transistor battery. When battery is weak the horn will emit an intermittent signal.
- Alarmed units are supplied with a micro switch, which monitors the push rail and the latch bolt and outside trim (if available) for foolproof security on rim devices
- Alarm unit has a signal OC output that can be linked to external alarm control systems
- Easy removal of the alarm unit without the need to dismount the exit device for battery maintenance
- Unit includes “**EMERGENCY EXIT ONLY ALARM WILL SOUND**” decal for application on door or unit

Rim Type Exit Devices

NALRM2200EO36	Alarm rim type 36” door (panic grade)
NALRM222048	Alarm rim type 48” door (panic grade)
FNALRM220036	Alarm rim type 36” door (fire grade)
FNALRM222048	Alarm rim type 48” door (fire grade)

Vertical Rod Type Exit Devices

Prefix “NALRM” before MODEL #.

Power Supplies

Power supplies for electrified exit devices are available.
See pages 95-96.

Trim Selection

CLUTCH CYLINDRICAL LEVER

Non-Handed Grade 1 (Clutch Style)

Cylindrical body hardened steel heavy duty tailpiece. For 1 3/4" and 2 1/4" doors. Prefix "THI" before Part # for 2 1/4" door thickness.

Available for Fire and Non-Fire Rated **Rim, SVR, and 3-PT Type Exit Devices**. Rose diameter 3 1/2", lever length 4 3/4". Fits and covers 161 cutout.

Finishes: US26D, US26, US3, US4, US10B, US10BE, US1

***GN DESIGN ONLY: ENT00L, ICENT00L, STR05L, ICSTR05L, PAS30L, DUM40L IN US32D FINISH, ALL STAINLESS STEEL EXTERIOR. INCLUDES GRADE 304SS LEVER AND ROSE**

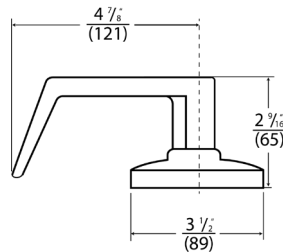
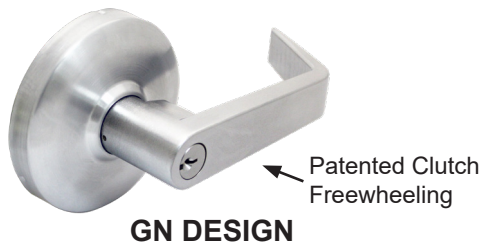

- ENT00L or
- ICENT00L or
- ICSCENT00L4
- SARICENT00L (Sargent)
- RUSICENT00L (Corbin / Russwin)
- YALICENT00L (Yale)
- 8000K
- STR05L or
- ICSTR05L or
- ICSCSTR05L4
- SARICSTR05L (Sargent)
- RUSICSTR05L (Corbin / Russwin)
- YALICSTR05L (Yale)
- PAS30L
- DUM40L

- ENTRANCE**
Key locks and unlocks lever. Operates as CLASSROOM FUNCTION. ANSI Function (08)
- Ball Knob Keylock
- STOREROOM**
Key operates lever, otherwise always locked. ANSI Function (09)
- PASSAGE**
Trim always operable and free. ANSI Function (14)
- DUMMY**
Dummy trim. One sided ANSI Function (02)

KEYWAY: 6-Pin solid brass "C" keyway standard. Optional: Schlage E, Schlage C-K, Russwin D1-2-3-4, Corbin 59/60, Sargent LA-LB-LC, Falcon/Weiser E, Arrow A, Yale 8, Yale GA and Kwikset. Can also accept Medeco, Assa, Kaba and **Cal-Royal HSK** High Security Cylinders.

- (IC) **INTERCHANGEABLE CORE:** Interchangeable Core locks will accept compatible 6 or 7-Pin cores with **BEST, FALCON and ARROW**.
- (ICSC) **INTERCHANGEABLE CORE:** Indicates function available with **SCHLAGE, CORBIN/RUSSWIN, SARGENT and YALE Full Size Format Interchangeable Core**

KEYWAY	+	DESIGN	+	FUNCTION	+	FINISH
BEST, FALCON, & ARROW - SCHLAGE - CORBIN/RUSSWIN - SARGENT - YALE -	}	IC ICSC RUSIC SARIC YALIC	}	AT SPA TUB* AUG DAN LON TAC	}	ENT00L STR05L PAS30L DUM40L
HOW TO ORDER IN LFIC						Example: ICSCENT00L4 US26D in "SPA" design is ICSCSPAENT00L4 US26D

**Note: Yale LFIC is only available in GN, AT, SPA lever designs | TUB* is only available in SFIC.

Other Lever Trim Designs

- Available in SFIC & LFIC **AT**
- Available in SFIC & LFIC **SPA**
- Available in SFIC **TUB**
- Available in SFIC & LFIC **except YALE LFIC* **AUG**
- Available in SFIC & LFIC **except YALE LFIC* **DAN**
- Available in SFIC & LFIC **except YALE LFIC* **LON**
- Available in SFIC & LFIC **except YALE LFIC* **TAC**
- 8000K**

Anti-Microbial Coating available in US26D or US32D Only. Use part # "ANTB-TRIM" when ordering.

Trim Selection

RIGID LEVER ESCUTCHEON



CONSTRUCTION

- Grade 1, thru-bolted design, rigid non-clutch, Non-handed design.
- Easily field reversible.
- Hardened steel heavy duty tailpiece.
- Available for Fire and Non-Fire Rated **Rim, SVR, and 3-PT Type Exit Devices.**
- Standard 6-Pin Schlage "C" Mortise Cylinder included

FINISHES

- Powder Coated Aluminum (ALUM)
- Powder Coated Dark Bronze Duranodic (DURO)
- Powder Coated Gold (GOLD)
- Powder Coated Black (US1)

DOOR THICKNESS

Standard 1 3/4". For 2 1/4" thick door use additional PART # TAIL3.

ESCUTCHEON DIMENSIONS

2 3/4" width x 8 3/4" length. Lever length: 4 3/4".

Fits and covers 2 1/8" 161 cutout



NESC2200 or ● ICNESC2200 or ● ICSCNESC2200	ENTRANCE Rigid Entrance, key locks or unlocks escutcheon trim ANSI Function (08) Operates as classroom function
NESC2205 or ● ICNESC2205 or ● ICSCNESC2205	STOREROOM Rigid Storeroom, key unlocks lever, lever retracts latch bolt, otherwise always locked ANSI Function (09)
NESC2230	PASSAGE Trim always operable and free ANSI Function (14)
NESC2240	DUMMY Dummy Escutcheon trim ANSI Function (02)

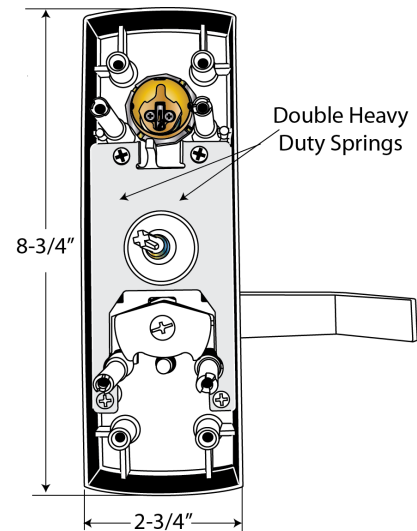

KEYWAY: 6 pin solid brass "C" keyway Mortise Cylinder standard. Optional: Schlage E, Schlage C-K, Russwin D1-2-3-4, Corbin 59/60, Sargent LA-LB-LC, Falcon/Weiser E, Arrow A, Yale 8, Yale GA and Kwikset. Can also accept Medeco, Assa, Kaba and **Cal-Royal HSK** High Security Cylinders.

● **(IC) INTERCHANGEABLE CORE:** Interchangeable Core locks will accept compatible 6 or 7-Pin cores with BEST, FALCON and ARROW

● **(ICSC) INTERCHANGEABLE CORE:** Indicates function available with **Schlage Full Size Format** Interchangeable Core. Corbin, Sargent and Yale format also available.

FOR ELECTRIFIED TRIM OPTIONS SEE PAGE 76

Trim Selection

PULL DESIGN



2200PULNL
IC2200PULNL
ICSC2200PULNL



FOR RIM DEVICES ONLY
 Outside by pull and key.
 Key retracts latch bolt.
 ANSI Function (03).
 Covers 161 cutout.
 Standard Rim Cylinder
 available in "C" 6-Pin and
 optional Kwikset KW keyways
 included.

2200 NL
IC2200NL
ICSC2200NL



FOR RIM DEVICES ONLY
 Outside by pull and key.
 Key retracts latch bolt.
 ANSI Function (03).
 Covers 161 cutout. Standard
 Rim Cylinder available in "C"
 6-Pin and optional Kwikset
 KW keyways included.

2200DTP



Outside by pull only.
 Pull when dogged.
 ANSI Function (02)
 Covers 161 cutout.

2200EOP



Outside by plate only.
 ANSI Function (01)
 Covers 161 cutout.

8000K
ENTRANCE



Key locks and unlocks knob.
 Operates as classroom
 function. ANSI Function (08)

THUMBPIECE TRIM

(OPERATES ON RIM & VERTICAL ROD DEVICES)

THP00 or
ICTHP00
ICSCTHP00

ENTRANCE
 Key locks or unlocks thumbpiece.
 (Operates as classroom function)
 ANSI Function (05)

THP05 or
ICTHP05
ICSCTHP05

STOREROOM
 Key unlocks thumbpiece, thumbpiece retracts
 latch bolt, otherwise always locked.
 ANSI Function (06)

THP30

PASSAGE
 Trim always operable and free.
 ANSI Function (15)

THP40

DUMMY
 Dummy trim. Includes blank Mortise
 dummy cylinder.
 ANSI Function (02)

KEYED



DUMMY

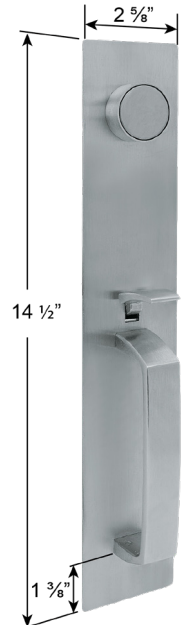

FINISHES

Powder coated Aluminum, Dark Bronze (DURO), Gold for PULL and THUMBPIECE TRIMS.
 US32D,3,10B for 8000K knob trim.

KEYWAY: 6 pin solid brass "C" keyway Mortise Cylinder standard. Optional: Schlage E, Schlage C-K, Russwin D1-2-3-4, Corbin 59/60, Sargent LA-LB-LC, Falcon/Weiser E, Arrow A, Yale 8, Yale GA and Kwikset. Can also accept Medeco, Assa, Kaba and **Cal-Royal HSK** High Security Cylinders.

⚙️ (IC) INTERCHANGEABLE CORE

Interchangeable Core locks will accept compatible 6 or 7-Pin cores with BEST, FALCON and ARROW.

⚙️ (ICSC) INTERCHANGEABLE CORE

Indicates function available with **Schlage Full size format** Interchangeable Core. Corbin, Sargent and Yale format also available.

DOOR THICKNESS

Standard 1 3/4". For 2 1/4" thick door use additional PART # TAIL 7.

Heavy Duty Mechanical Push Button Lock



MECHANICAL CRCODE204

Features

- Breakaway Lever Design
- Easy On-Door Code Change
- Weather Resistant
- Code-Free Option (Passage)
- Non-Handed
- 1 - 12 digit Length Code
- Thousands of Possible Code Combinations
- Single Code User
- Applications: Offices, Schools, Hospitals, Apartments, Hotels/Motels, Residential, Commercial and Public Buildings
- Door Thickness: 1 3/4" - 2"
- 2-year limited warranty



Electrified Lever Trim

Cal-Royal's electrified lever trim provides remote locking and unlocking capabilities using industry safety standards. The solenoid can be energized from a distant controller, thus allowing access control of the opening. The control of stairwells in high-rise buildings is a common application for this trim, where electric pullback of the exit device's latch bolt is cost prohibitive or not required.

This is especially practical in applications where fire / life safety codes require a "fail-safe" condition which is not an option with electrified latch pullback devices. Because the current draw is quite low there is no need for a more expensive power supply to provide the surge current.

Features

- Continuous duty solenoids used to insure trouble-free operation
- No hassle 3-Year Warranty
- Requires additional door prep

Specifications

Solenoid..... Continuous Duty
 Operating Voltage.... 11-30VDC / 10-24VAC
 Amperage..... 330mA @ 11V / 140mA @ 30V
 Coil Resistance..... 8.2 Ω
 Function.... available Fail Safe, Electrically Locked (EL)
 or Fail Secure, Electrically Unlocked (EU)



ITEM#	DESCRIPTION
NESC22-EL ● ICNESC22-EL ● ICSCNESC22-EL	EL (Electrically Locked, Fail Safe), Voltage: 11-30VDC / 10-24VAC
NESC22-EU ● ICNESC22-EU ● ICSCNESC22-EU	EU (Electrically Unlocked, Fail Secure), Voltage: 11-30VDC / 10-24VAC

● (IC) INTERCHANGEABLE CORE: Interchangeable Core locks will accept compatible 6 or 7-Pin cores with BEST, FALCON and ARROW

● (ICSC) INTERCHANGEABLE CORE: Indicates function available with Schlage Full Size Format Interchangeable Core. Corbin, Sargent and Yale format also available.

(ELR) Electric Latch Retraction

Our motor driven electrified latch pullback exit device allows for remote keyless access control in high occupancy / high traffic conditions where exit devices are required. Common applications include conditions such as hospitals, airports, schools, churches and they are commonly specified in applications that require automatic door openers. The device may be continuously energized allowing for a push / pull condition if desired.

Features:

- Available on 2200 Series, including **Rim, Vertical Rod, Concealed Vertical Rod, Mortise Rim Type** fire and non fire-rated exit devices
- MM4 Smart Module: On board diagnostics with audible feedback for adjustment and power issues
- “PTS” (Push to Set Technology): 5 second electronic adjustment for easy post installation adjustment
- Electric dogging rated for continuous duty - Auto retraction if dogged push pad is pulled from position
- Low Current Draw - Field switchable to “High Torque” mode
- Up to 300’ wire run with (2) 18ga wire - Long wire runs provides installer with convenience of placing the locking device power supply in a centralized location; i.e. the same closet as the access panel
- 8’ cable with Quick Connect for MM4 module to easily connect to power supply lead
- 3-year “No Hassle” warranty

Specifications:

- Voltage – 24 to 28V DC
- System protection – unit shutdown when voltage exceeds 28V DC
- Average In-rush Current – 900mA; Average Hold Current - 215mA
- PTS adjustment – approx. 1/4”
- Wire run: 300’ with 18ga wire

INSTALLED ON THE EXIT DEVICE: USE FLR2298 ADD

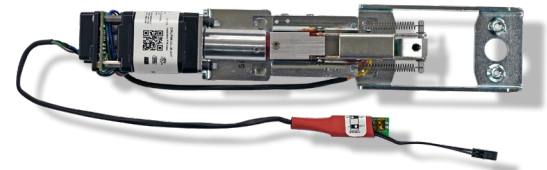

FOR FIELD INSTALLATION USE FLR2298 KIT

To Order:

- **Must Specify: Exit Device item #** and **FLR2298 ADD** as two separate line items.
For Example: A2200EO36 US32D with ELR option, order “**A2200EO36 US32D**”, and “**FLR2298 ADD**” as two line items.
- ***Use FLR2298 KIT if ordered separately.**
- **Optional Switch (RX or LX)** is also available and should be added as a 3rd line item as needed.

Note: When using electrified hinge, you must use prefix ELELRn + hinge item code, where “n” is equal to number of wires. For example: ELELR4 + BB31.

MUST USE CRP POWER SUPPLIES TO HONOR WARRANTY (see pages 95-96)

Signal Switch RX and LX

RX (request to exit) signal switch is used to signal the use of an opening from the push side. When the push pad is depressed, the switch is activated. These devices are equipped with an internal SPDT (single pole double throw) switch that monitors the touch bar.
LX (latch bolt monitoring) signal switch monitors both egress and access of an opening. When the latch bolt is retracted, the switch is activated. These devices are equipped with an internal SPDT (single pole double throw) switch that monitors the latch bolt position.
LX and **RX** switches can be combined.

LX, RX switches can be used in combination with ELR (electric latch retraction) option.

Specifications

RX or **LX**.....Switch rated 0.5 amps @ 24V AC / DC resistive
Low current **RX** or **LX**.Switch rated 0.5 amps @ 24V AC / DC resistive

for Factory Installed. To Order, Specify:

- RX22/98**.....Request to Exit switch for field installation
- LX2200**.....Latch bolt Monitoring switch for field installation
- LXRX2200**.....Latch bolt Monitoring / Request to Exit Combination

KABA® - Cal-Royal Combination

Cal-Royal’s Exit hardware devices combined with Kaba InSync CP provide a variety of alternatives when addressing community access control. Recommended for applications such as controlling building entry openings, common area rooms and doors with exit devices. **InSync CP** are available as stand-alone battery operated door locks designed to work in conjunction with **Cal-Royal’s Exit Hardware Devices**.



KABA InSync CP is not sold through CAL-ROYAL. For inquiries and information on InSync line of products please visit www.kabamultihousing.com

Strikes & Accessories



Strikes for use with A2260V Vertical Rod Exit Device All strikes are black nylon coated

221
Standard for A2260V.
Applied to surface of floor or to a flat threshold.
Standard packaging.

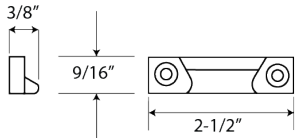

227
Applied to surface of stop.
No mortise required.
Standard packaging.

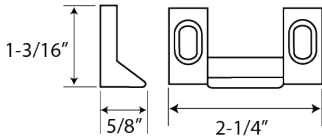

233
Bottom strike. Alternate bottom strike. Flush mounting stainless steel. Furnished with expansion shields.
Requires mortise in the floor.

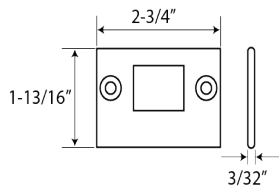

RIM238
Strike for 2 3/8"
Backset Application

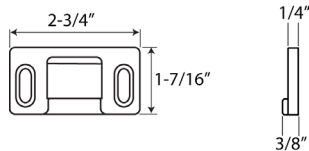

Overlapping Strikes

N251
Surface applied. Used on inactive leaf for device on active leaf of pair of doors without mullion

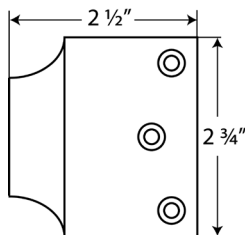

Additional Rods

Vertical rod for 10 feet high doors.
Available on non-fire rated vertical rod devices only.
Use Part # **VRRD10**

Strikes for use with AF2260V Vertical Rod Fire Exit Device

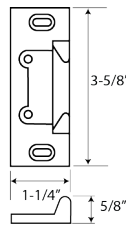

245
Surface applied for AF2260V.
Standard packaging.

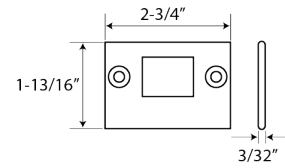

233
Bottom strike for AF2260V. Flush mounting stainless steel. Furnished with expansion shields. Requires mortise in the floor.
Standard packaging.

Additional Accessories

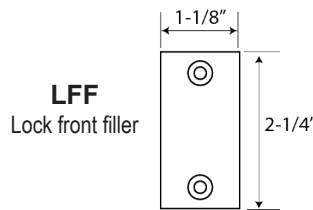

LFF
Lock front filler

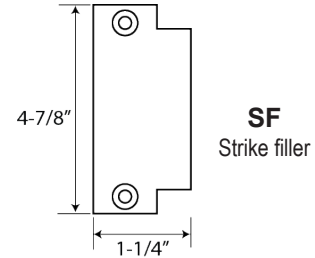

SF
Strike filler

Strikes for use with A2200 Rim Type Exit Device

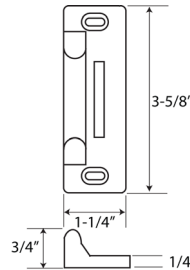

239
For A2200 surface applied.
Standard packaging

Strikes for use with AF2200 Rim Type Fire Exit Device

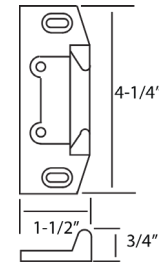

245
For AF2200 surface applied.
Standard packaging.

ADA Roller Strike for A2200, AF2200 Fire and Non-Fire Rim Exit Devices

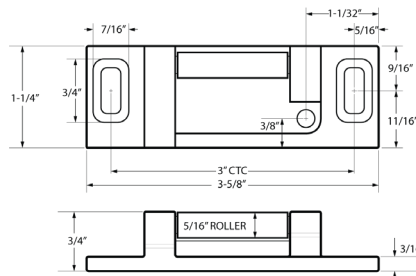

945 (NON-FIRE RATED)
945F (FIRE RATED)

Strikes & Accessories

Strikes for 98-3PT & F98-3PT, Fire and Non-Fire Exit Devices

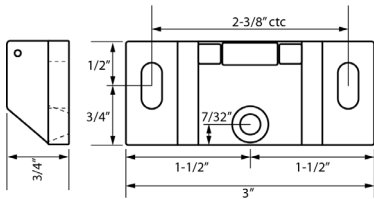

610
Roller Rim Strike,
surface applied.
Standard Packaging.

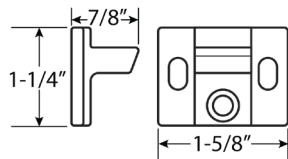

620
Top Strike.
Standard packaging.

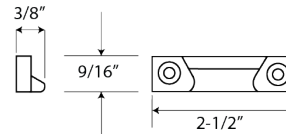

221
Handicap Bottom Strike.
Applied to surface of floor
or to a flat threshold.
Standard packaging.

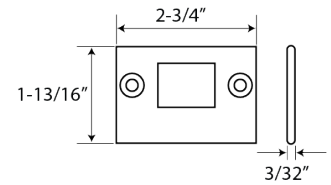

233
Bottom strike.
Flush mounting stainless steel.
Furnished with expansion shields.
Requires mortise in the floor.

GLASS BEAD SHIM KITS

- 401** – for Rim type, 1/8" thick
- 406** – for SVR type, 1/8" thick
- 412** – for fire rated SVR type, 1/8" thick

When exit devices are used with shim kits with outside trim, spindle length thumbpiece and thru bolt length must be increased accordingly.

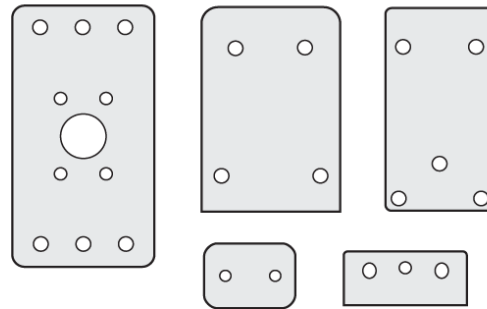

406-3
for 22-3PT type,
1/8" thick

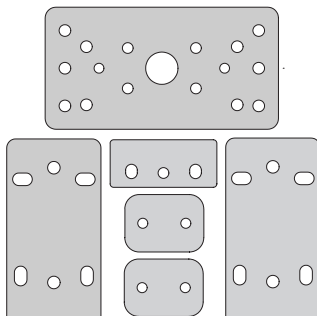

412-3
for F22-3PT type,
1/8" thick

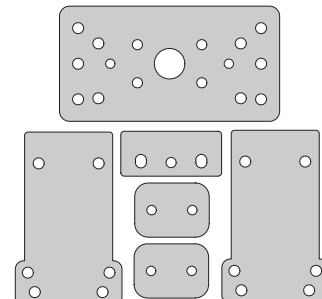

STANDARD HEX DOGGING KIT



(For Non-Rated Panic Bar)
PART # **DOGGINGKIT** (2200 Series)

CYLINDER DOGGING KIT

TO ORDER: Prefix "CD" before PART #.
Available for all 2200 Series devices except
fire exit hardware. Cylinder dogging with
mortise cylinder is located on the mounting
insert lock bolt in retracted position.



To order **KIT ONLY:** use PART # 36CD2200 for 36" and 48CD2200 for 48" devices.
Specify finish.

KEYWAYS: 6-Pin solid brass "C" keyway standard. Optional: Schlage E, Schlage C-K, Russwin
D1-2-3-4, Corbin 59/60, Sargent LA-LB-LC, Falcon/Weiser E, Arrow A, Yale 8, Yale GA and Kwikset.
Can also accept Medeco, Assa, Kaba and **Cal-Royal HSK** High Security Cylinders.