



# INSTALLATION INSTRUCTIONS FOR AF7700 SERIES FIRE RATED EXIT DEVICE

## BEFORE INSTALLING DEVICE, PLEASE CHECK:

1. IF DOOR FITTED AND HUNG
2. SIZE OF EXIT DEVICE, FUNCTION AND DESIGN.
  - 2.1 36" DEVICES CAN BE CUT TO FIT DOORS DOWN TO 30" WIDE.
  - 2.2 48" DEVICES CAN BE CUT TO FIT DOORS DOWN TO 36" WIDE.
  - 2.3 HAND OF DEVICE AGAINST APPLICATION.

SURFACE OF DOOR FOR EXIT DEVICE APPLIED MUST BE FLUSHED.

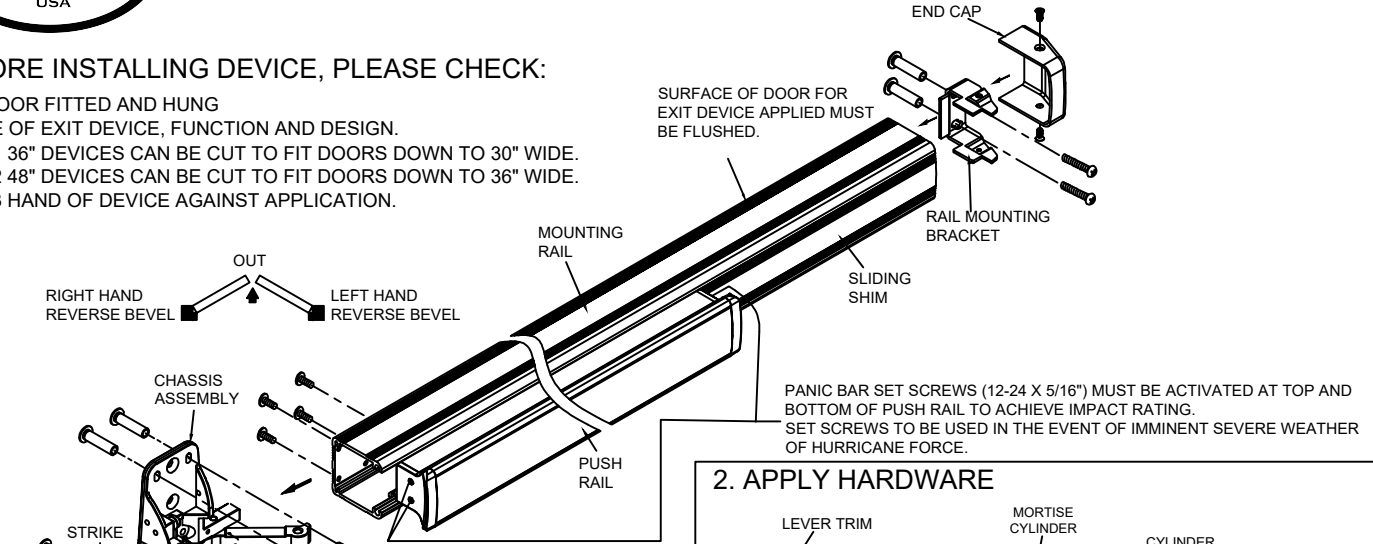

## 2. APPLY HARDWARE

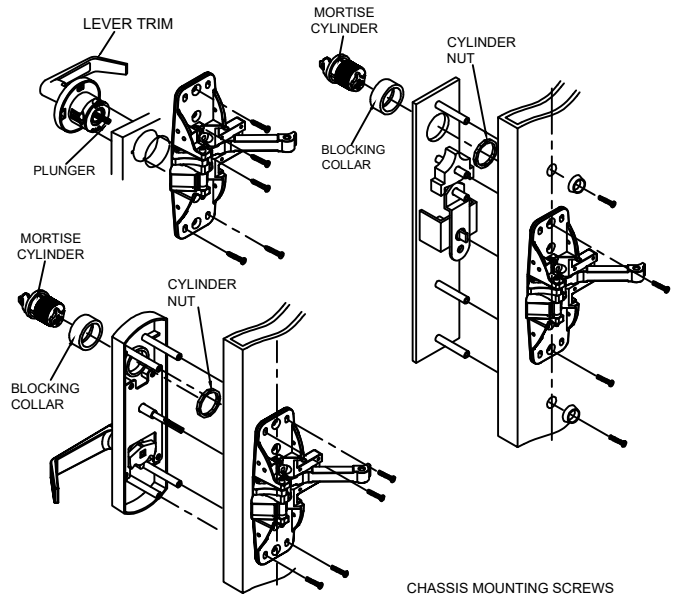

### AUX BOLT & LATCH BOLT INSTALLATION INSTRUCTION

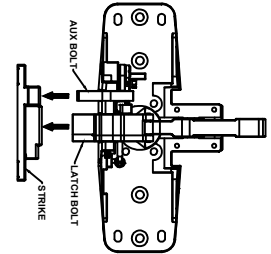

## 1. PREPARED DOOR

- 1.1 FOR 2-1/8" Ø BORE PREP. POSITION TEMPLATE OVER EXISTING HOLE AND MARK FOR TWO CHASSIS MOUNTING SCREW HOLES.

ENSURE VERTICAL CHASSIS PARALLEL TO DOOR EDGE.

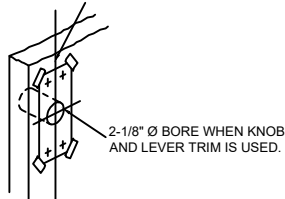

- 1.2 FOR DOOR W/O BORE PREP, MARK VERTICAL CHASSIS AND HORIZONTAL CHASSIS USING DIMENSION BELOW. MOUNTING SCREW HOLES.

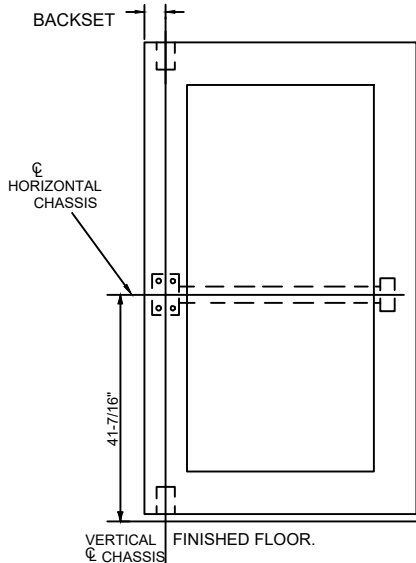

### IDENTIFY TYPE OF INSTALLATION TO DETERMINE LOCATION OF VERTICAL CHASSIS

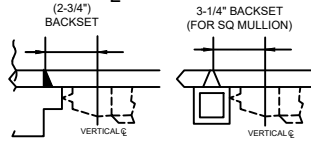

## 3. APPLY RAIL ASSEMBLY

- 3.1 CHECK THE SIZE OF DEVICE, IF CUTTING TO LENGTH IS REQUIRED.
- 3.2 DETERMINE CUT OFF LENGTH "X" BY SUBTRACTING 1-3/4" FROM "Y". MARK CUT OFF POINT ON MOUNTING RAIL
- 3.2 DEPRESS ARM INTO RAIL OPENING AND SLIDE RAIL ONTO CHASSIS. LEVEL RAIL AND FASTEN CHASSIS AND MOUNTING PLATE.

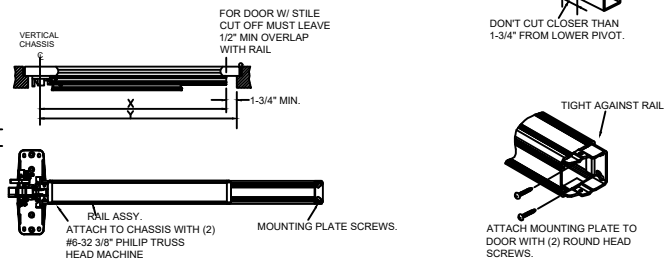

## 4. APPLY COVER AND STRIKES

