

HOSPP SERIES

Grade 1 Heavy Duty Hospital Latch



MEETS
The Buy American Act

FEATURES

- UL-listed for use on all fire doors
- Meets ADA requirements
- Ideal for use in hospitals, washrooms or public buildings
- Can be installed in 6 different mounting positions
- Covers and paddles are made of stainless steel
- Non-Handed
- Standard T-Strike and Plastic Dust Box
- 1 3/4" door thickness
- 2 3/4" backset standard, face plate 1 1/8" x 2 1/4"
- Optional 5" backsets
- 2 5/8" x 4 3/8" Covers
- 2 5/8" Handle Projection, Anti-microbial coating option available
- Lead lining option available for doors with lead lining
- Optional ASA ANSI Strike



HOSPP-30

MODEL#	FUNCTION	FINISH
HOS-PP20	PRIVACY	US32D
HOS-PP30	PASSAGE	

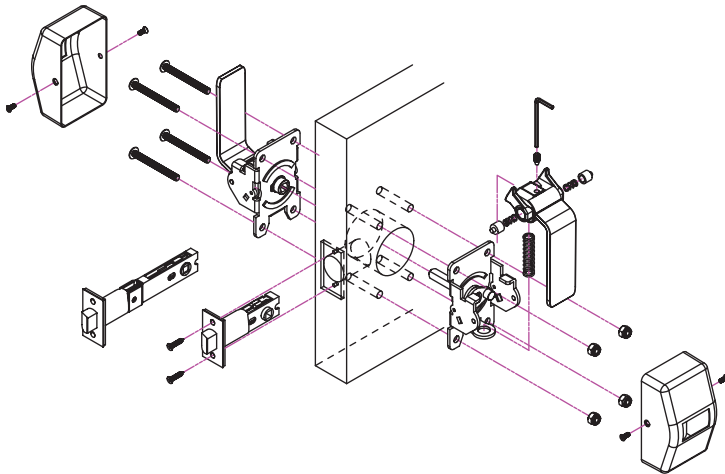

The hospital push / pull latch allows for easy opening of doors with an easy push or pull action using elbows or hips when hands are not free.

Ideal for use in commercial applications, institutions, hospitals, washrooms or public buildings.

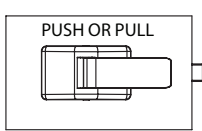

PUSH OR PULL

HORIZONTAL WITH 5" BACKSET

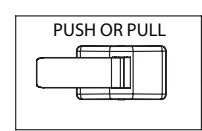

PUSH OR PULL

HORIZONTAL WITH 2-3/4" or 5" BACKSET

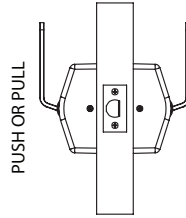

PUSH OR PULL

VERTICAL UP (INSIDE)
UP (OUTSIDE)

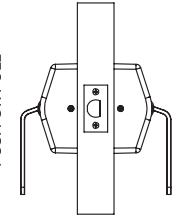

PUSH OR PULL

VERTICAL DOWN (INSIDE)
DOWN (OUTSIDE)

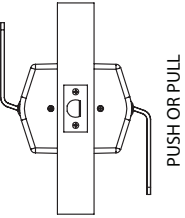

PUSH OR PULL

VERTICAL UP (INSIDE)
DOWN (OUTSIDE)

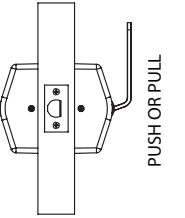

PUSH OR PULL

VERTICAL DOWN (INSIDE)
UP (OUTSIDE)

INSTALLATION OPTIONS