

GLS7700 & FGLS7700 Series

GRADE 1 Rim Type Narrow Stile Exit Device

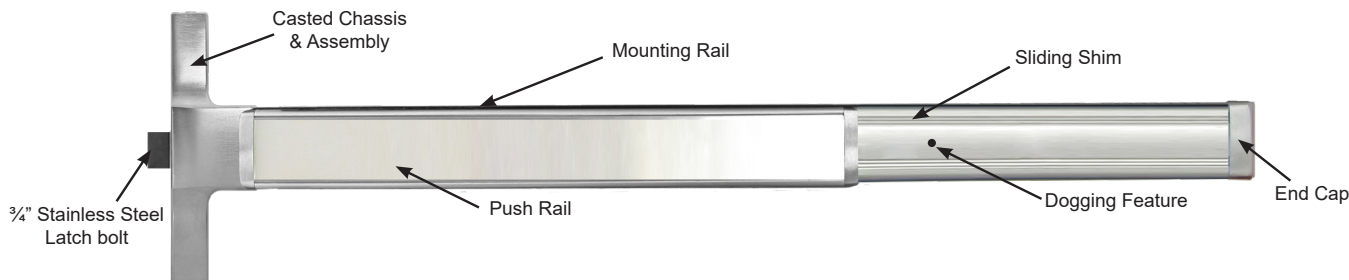

Specifications

For Doors.....	Wood, Metal or Aluminum Glass doors with 1 3/4" minimum stile width, 1 3/4" thickness for single or double door application
Chassis.....	Non-ferrous Alloy (Panic Grade)
Cover.....	Non-ferrous plated material.
Mounting.....	Furnished with wood and machine screws. Thru-bolts available upon request.
End Cap.....	Brass, Bronze or Stainless Steel construction
Alarm.....	Available for 36" bar only. Prefix "NALRM" before PART #
Hand.....	Non-handed
Latch Bolt.....	Stainless Steel 3/4" throw
Spring.....	Stainless Steel throughout
ANSI Standard.....	A156.3, Grade 1
Rail Assembly.....	Heavy gauge extruded aluminum body with Stainless Steel push pad
Strike.....	246 packed standard. Optional 247 strike. (See strike page)
Dogging Feature.....	Available for 36" bar only. Allen-type key furnished standard.
Mullion.....	Available
UL and ULC Listed.....	GLS7700 Series for Panic & Safety for all types of 4' x 8' single doors and 8' x 8' double doors. FGLS7700 Series for all types of 4' x 8' single doors for up to 3 hour fire labeled installations. Conforms to UL10C and UBC7-2-1997 codes.
Finish.....	Architectural plated finishes
Electronic Functions.....	(ELR) Electrical Latch Retraction and RX & LX Signal Switch available
Anti-Microbial Coating.....	Available on US32D only. Use part # ANTB-EXIT

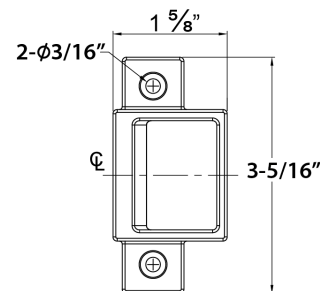

246 STRIKE

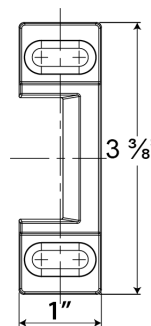

247 STRIKE (OPTIONAL)

DIMENSIONS

Push Rail height to finished floor	41" (1041 mm) at center		
Push Rail projection			
Neutral	3 5/8" (92 mm)		
Depressed	2 7/8" (73 mm)		
Center case	8 1/16" x 1 1/8" x 2 3/8" (205 mm x 29 mm x 60 mm)		
MODEL	ACTUAL LENGTH	MAX CUT DOWN	DOOR SIZE
GLS7700EO36, FGLS7700EO36	34 9/64"	10"	26" to 36" width
GLS7700EO48, FGLS7700EO48	45 29/32"	12"	36" to 48" width