



Weather Seal Door Accessories

INT-880 Adhesive Gasketing Tool with Intumescent

INT-880

Adhesive Gasketing
Seal around the door

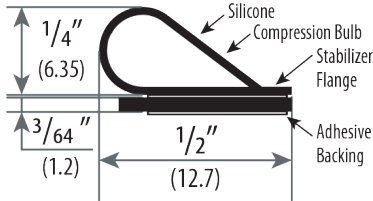

ITEM INFO:

INT-880

(C-880 w/ INT-001 COMBO)

Length: **36" x 84"**,
48" x 96",
96" x 96"

Available Finishes:
B (Black), **W** (White)

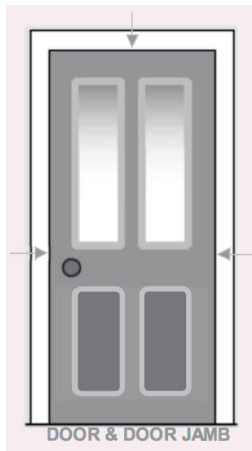

Seal gap between door and door jamb. Apply to Top part and both sides of the door jamb.

Installation Guidelines for INT-880 Adhesive Gasketing

Door Frame Preparation:

Clean the door frame thoroughly with a good cleaning agent that removes any particles that can affect the adherence of the gasket, dust, or cleanser build-up. Check the frame surface if it is completely dry before installation. Always use a cleaning agent that is not a petroleum base.

Preferred schedule for installation:

The best time (schedule) to install the **ADHESIVE GASKET** is when most of the major work in construction has been completed or change occupancy maintenance field of work. Where area is already in the cleaning phase of the project time table. This is important to avoid foreign particles on the frame and the adhesive during installation.

Important Reminder and Notice:

1. When handling the adhesive gasket, avoid extending or expanding the item. It may deform in size or affect the quality of the item.
2. Apply steady straight pressure when installing the gasket. Use appropriate tools like seam roller to strengthen the gasket.
3. Avoid expanding the material when applying pressure using roller.
4. Inspect the gasket adhesion after a few hours that it has been installed.
5. Make sure to apply enough pressure when putting the gasket in the **HEAD JAMB**.

Tools Required:

- Cutting tools
- Rugs

Packaging includes:

- Frame cleaner (1 pc)
- Seal sticker (1pc)

TESTING / RATINGS:



GASKETING MATERIAL FOR FIRE DOORS INTENDED FOR APPLICATION TO
UL LISTED STEEL FRAMES AND/OR CLASSIFIED STEEL COVERED COMPOSITE TYPE,
AND HOLLOW METAL TYPE FIRE DOORS RATED UP TO 3HRS;
WOOD AND PLASTIC COVERED COMPOSITE TYPE FIRE DOORS RATED UP TO 1-1/2 HRS;
AND WOOD CORE TYPE FIRE DOORS RATED UP TO 20 MINUTES.
43ZY

Installation Guidelines Continued:

Installation Procedure:

1. Measure the exact length of the hinge jamb, strike jamb, and header jamb before cutting the seal.
2. Cut both ends of the upper corner of the gasket at 45° angle.
3. Peel off roughly 18" of backing from the adhesive gasket strip. Be careful not to touch the adhesive or drag it on the ground.
4. Place the adhesive gasket as illustrated below. **DO NOT STRETCH MATERIAL.** The use of a hand roller is highly recommended.
5. Remove the next 18" of paper backing and repeat step #3 until the entire length of the seal is installed. If a pre-cut length overruns a top or side, stretching has occurred. Remove it immediately and reapply.
6. Once installed, apply firm pressure along the entire surface of the product to ensure proper adhesion to the frame.
7. Check if the gasket is properly mounted around the perimeter of the door, thus prevents the foreign particles from coming inside and also helps to save energy from the HVAC system.

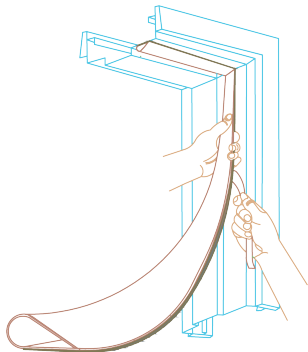
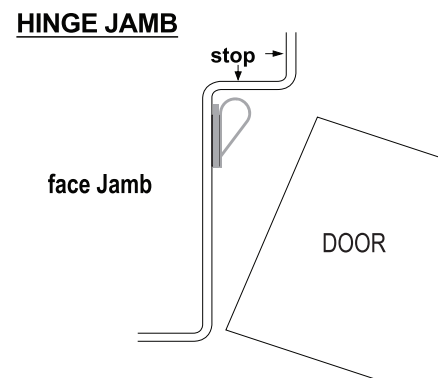
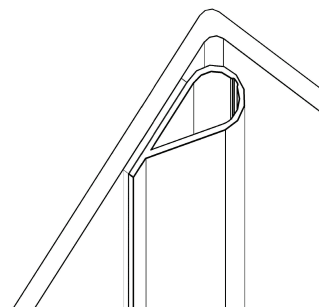
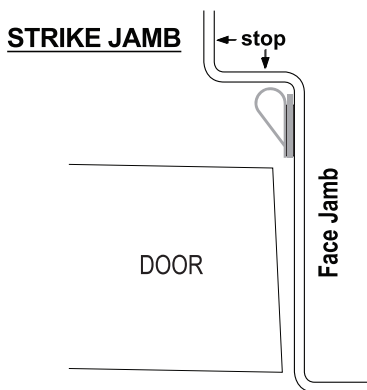
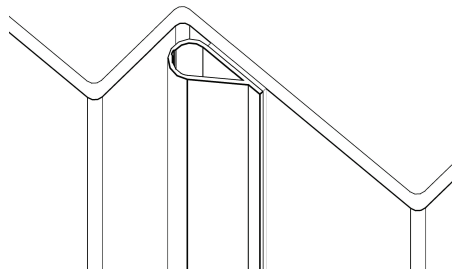
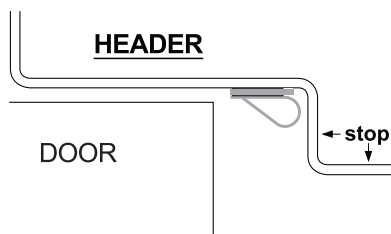
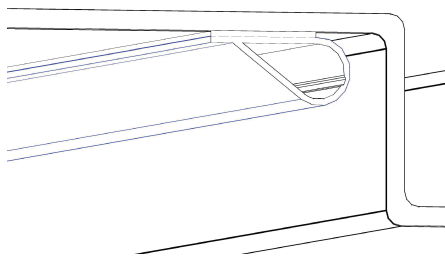

Note: Installing in different layout around the door jamb (head, hinge jamb, & strike jamb) is applicable as long as the door would be able to operate properly.